

# Mechanically Operated Pneumatic Valves

## 2/2 & 3/2 Way Compact Plunger Valve

### Technical information

<b>Pressure range:</b>	0-10 bar
<b>Temperature range:</b>	-15°C...+50°C
<b>Housing:</b>	Die-cast and lacquered zinc alloy
<b>Seals:</b>	PUR
<b>Lubricant:</b>	Not required
<b>Operating medium:</b>	5 micron filtered, lubricated or non-lubricated compressed air



### Other information

For NPT ports use prefix code "75" for example 75.XXX.XX.XX

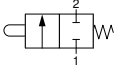
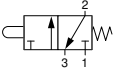
Symbol	Description	Type	Orifice	Ports	Order code
	2/2 way spring return normally closed	Poppet	4mm	G1/8	<b>76.025.21.21</b>
	3/2 way spring return normally closed	Poppet	4mm	G1/8	<b>76.026.21.21</b>

### Dimensional drawings

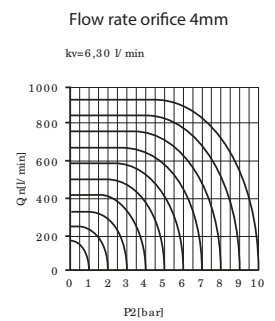
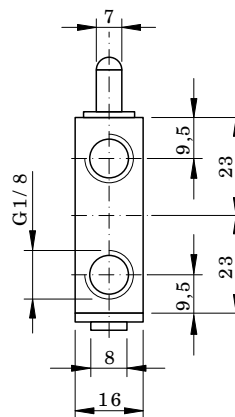
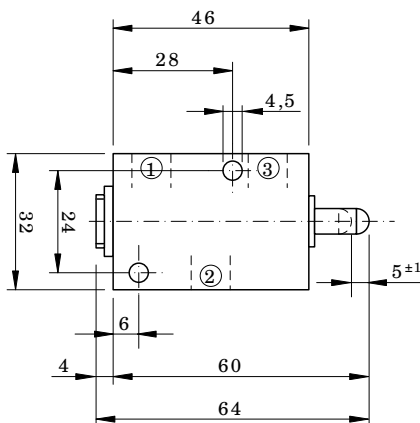

# Mechanically Operated Pneumatic Valves

## 3/2 & 5/2 Way Plunger Valve - Air Pilot Assisted



### Technical information

<b>Actuation force @ 6 bar:</b>	8N
<b>Pressure range:</b>	2.5-10 bar
<b>Temperature range:</b>	-15°C...+50°C
<b>Housing:</b>	Die-cast and lacquered zinc alloy
<b>Seals:</b>	NBR
<b>Lubricant:</b>	Not required
<b>Operating medium:</b>	5 micron filtered, lubricated or non-lubricated compressed air

### Other information

 For ATEX certification use suffix code "EX" for example 76.XXX.XX.XX.EX  
 For NPT ports use prefix code "75" for example 75.XXX.XX.XX

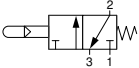
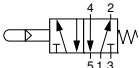
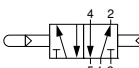
Symbol	Description	Type	Orifice	Ports	Order code
	3/2 way spring return normally closed	Spool	6mm	G1/8	<b>76.022.32.21</b>
	5/2 way spring return	Spool	6mm	G1/8	<b>76.023.32.41</b>
	5/2 way with plunger on both ends **	Spool	6mm	G1/8	<b>76.027.60.10</b>

### Dimensional drawings

\*\*Dimensional drawing upon request

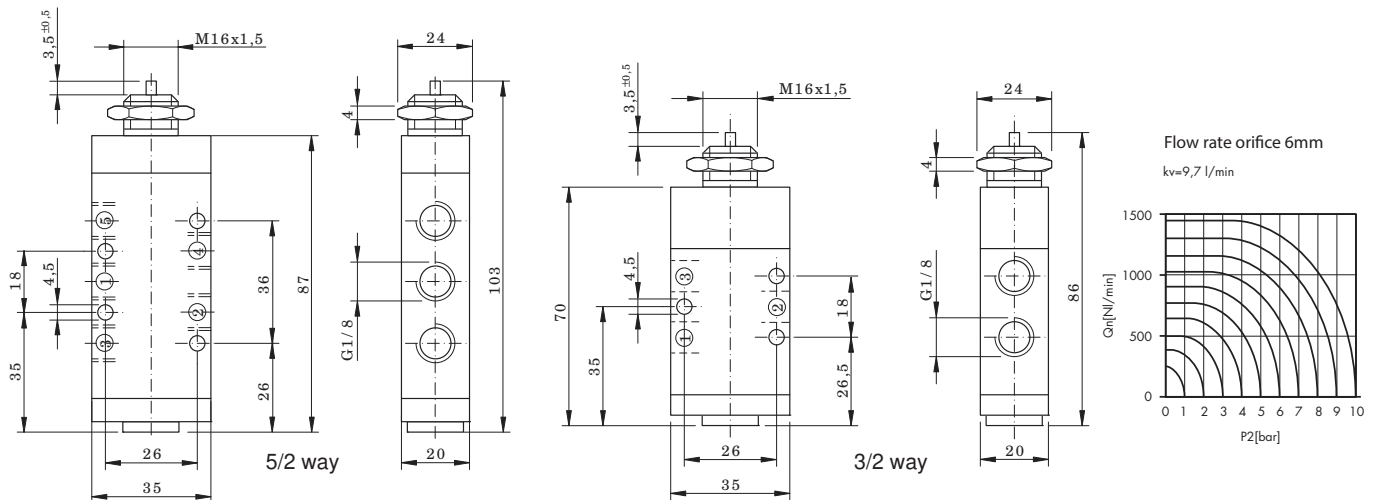

# Mechanically Operated Pneumatic Valves

## 5/2 Way Plunger Valve - Body Mounting

### Technical information

<b>Pressure range:</b>	0-10 bar
<b>Temperature range:</b>	-15°C...+50°C
<b>Housing:</b>	Die-cast and lacquered zinc alloy
<b>Seals:</b>	NBR
<b>Lubricant:</b>	Not required
<b>Operating medium:</b>	5 micron filtered, lubricated or non-lubricated compressed air

### Other information

 For ATEX certification use suffix code "EX" for example 76.XXX.XX.XX.EX  
For NPT ports use prefix code "75" for example 75.XXX.XX.XX

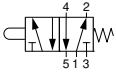
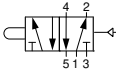
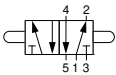

Symbol	Description	Type	Orifice	Ports	Order code
	5/2 way spring return	Spool	6mm	G1/8	<b>76.023.21.41</b>
	5/2 way maintained position with pilot return **	Spool	6mm	G1/8	<b>76.023.21.42</b>
	5/2 way with plunger on both ends **	Spool	6mm	G1/8	<b>76.023.21.10</b>

### Dimensional drawings \*\*Dimensional drawing upon request

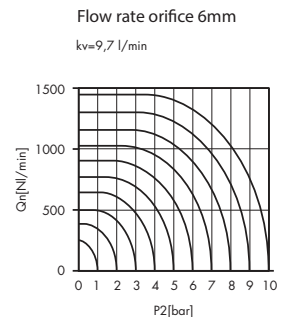
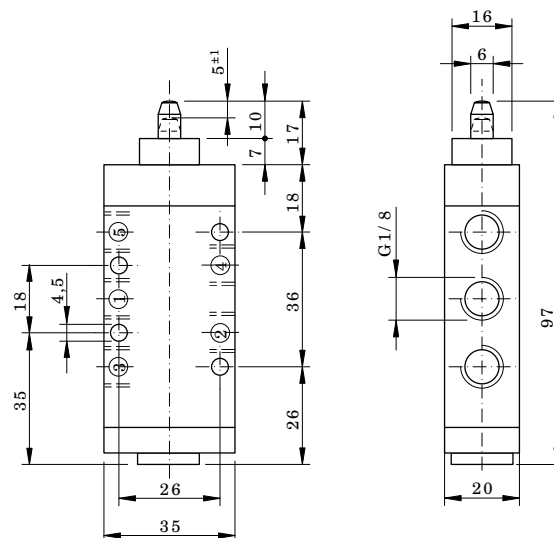

# Mechanically Operated Pneumatic Valves

## 3/2 & 5/2 Way Plunger Valve - Nose Mounting

### Technical information

<b>Pressure range:</b>	0-10 bar
<b>Temperature range:</b>	-15°C...+50°C
<b>Housing:</b>	Die-cast and lacquered zinc alloy
<b>Seals:</b>	NBR
<b>Lubricant:</b>	Not required
<b>Operating medium:</b>	5 micron filtered, lubricated or non-lubricated compressed air

### Other information

 For ATEX certification use suffix code "EX" for example 76.XXX.XX.XX.EX  
 For NPT ports use prefix code "75" for example 75.XXX.XX.XX

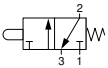
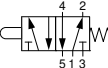

Symbol	Description	Type	Orifice	Ports	Order code
	3/2 way spring return normally closed	Spool	6mm	G1/8	<b>76.022.22.21</b>
	5/2 way spring return	Spool	6mm	G1/8	<b>76.023.22.41</b>

### Dimensional drawings

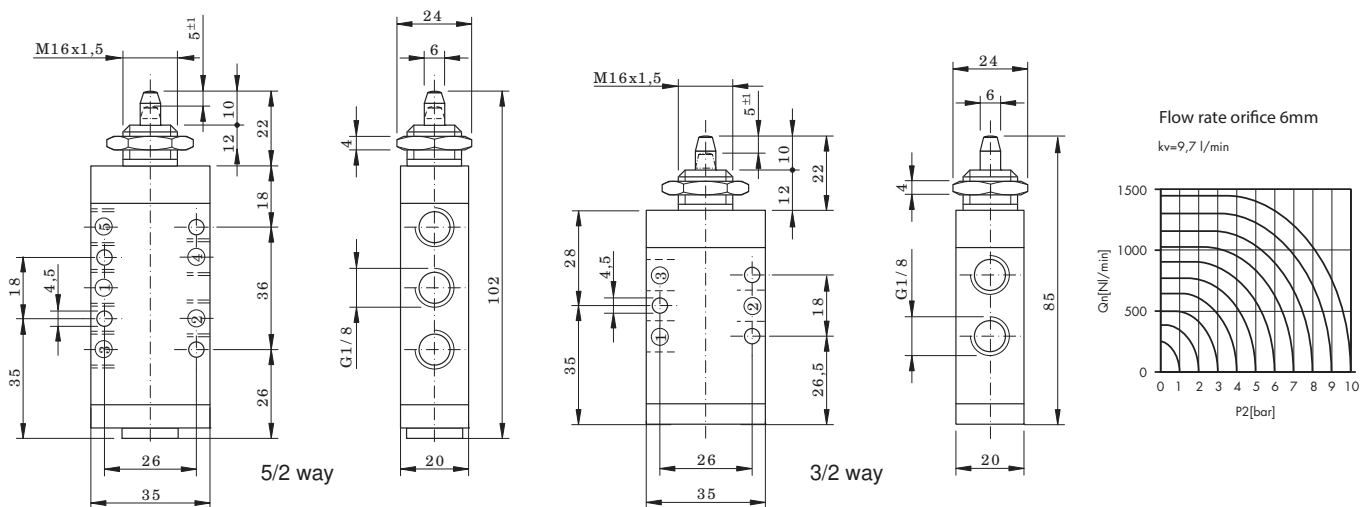

# Mechanically Operated Pneumatic Valves

## 3/2 Way Plunger Valve - Body Mounting

### Technical information

<b>Pressure range:</b>	0-10 bar
<b>Temperature range:</b>	-15°C...+50°C
<b>Housing:</b>	Die-cast and lacquered zinc alloy
<b>Seals:</b>	NBR
<b>Lubricant:</b>	Not required
<b>Operating medium:</b>	5 micron filtered, lubricated or non-lubricated compressed air



### Other information

 For ATEX certification use suffix code "EX" for example 76.XXX.XX.XX.EX  
 For NPT ports use prefix code "75" for example 75.XXX.XX.XX

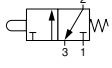
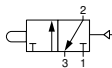
Symbol	Description	Type	Orifice	Ports	Order code
	3/2 way spring return normally closed	Spool	6mm	G1/8	<b>76.022.21.21</b>
	3/2 way maintained position with pilot return **	Spool	6mm	G1/8	<b>76.022.21.22</b>

### Dimensional drawings \*\*Dimensional drawing upon request

